



2010

WASHINGTON STATE

Joint Aquatic Resources Permit Application (JARPA) Form¹

USE BLACK OR BLUE INK TO ENTER ANSWERS IN WHITE SPACES BELOW.



US Army Corps of Engineers
Scientific Director

AGENCY USE ONLY

Date received:

Agency reference #:

122519-01

Tax Parcel #(s):

Part 1-Project Identification

1. Project Name (A name for your project that you create. Examples: Smith's Dock or Seabrook Lane Development) [help]²

Brain Bridge

Part 2-Applicant

The person or organization responsible for the project. [help]

2a. Name (Last, First, Middle) and Organization (if applicable)

Louie Gibson Gibson + Son

2b. Mailing Address (Street or PO Box)

1221 S. Thorp Hwy

2c. City, State, Zip

Ellensburg WA 98926

2d. Phone (1)

2e. Phone (2)

2f. Fax

2g. E-mail

(509) 728-8605

509 925-2017

509 925-5703

gibson@elltel.net

Part 3-Authorized Agent or Contact

Person authorized to represent the applicant about the project. (Note: Authorized agent(s) must sign 11b. of this application.) [help]

3a. Name (Last, First, Middle) and Organization (if applicable)

Louie Gibson Gibson + Son

3b. Mailing Address (Street or PO Box)

1221 S. Thorp Hwy Ellensburg WA 98926

¹Additional forms may be required for the following permits:

- If your project may qualify for Department of the Army authorization through a Regional General Permit (RGP), contact the U.S. Army Corps of Engineers for application information (206) 764-3495.
- If your project might affect species listed under the Endangered Species Act, you will need to fill out a Specific Project Information Form (SPIF) or prepare a Biological Evaluation. Forms can be found at http://www.nws.usace.army.mil/PublicMenu/Menu.cfm?sitename=REG&pagename=mainpage_ESA
- If you are applying for an Aquatic Resources Use Authorization you will need to fill out and submit an Application for Authorization to Use State-Owned Aquatic Lands form to DNR, which can be found at http://www.dnr.wa.gov/Publications/aqr_use_auth_app.doc
- Not all cities and counties accept the JARPA for their local Shoreline permits. If you think you will need a Shoreline permit, contact the appropriate city or county government to make sure they will accept the JARPA.

²To access an online JARPA form with [help] screens, go to

http://www.epermitting.wa.gov/site/alias_resourcecenter/jarpa_jarpa_form/9984/jarpa_form.aspx

For other help, contact the Governor's Office of Regulatory Assistance at 1-800-917-0043 or help@ora.wa.gov.

3c. City, State, Zip			
Ellensburg WA 98924			
3d. Phone (1)	3e. Phone (2)	3f. Fax	3g. E-mail
(509) 925-2017	(509) 728-8605	(509) 925-5703	gibson@elltel.net

Part 4—Property Owner(s)

Contact information for people or organizations owning the property(ies) where the project will occur. [\[help\]](#)

- Same as applicant. (Skip to Part 5.)
- Repair or maintenance activities on existing rights-of-way or easements. (Skip to Part 5.)
- There are multiple property owners. Complete the section below and fill out [JARPA Attachment A](#) for each additional property owner.

4a. Name (Last, First, Middle) and Organization (if applicable)			
Gene BRAIN			
4b. Mailing Address (Street or PO Box)			
7714 Taneum Rd West			
4c. City, State, Zip			
Thorp WA 98944			
4d. Phone (1)	4e. Phone (2)	4f. Fax	4g. E-mail
(509) 964-2297	()	()	

Part 5—Project Location(s)

Identifying information about the property or properties where the project will occur. [\[help\]](#)

- There are multiple project locations (e.g., linear projects). Complete the section below and use [JARPA Attachment B](#) for each additional project location.

5a. Indicate the type of ownership of the property. (Check all that apply.) [help]			
<input type="checkbox"/> State Owned Aquatic Land (If yes or maybe, contact the Department of Natural Resources (DNR) at (360) 902-1100)			
<input type="checkbox"/> Federal			
<input type="checkbox"/> Other publicly owned (state, county, city, special districts like schools, ports, etc.)			
<input type="checkbox"/> Tribal			
<input checked="" type="checkbox"/> Private			
5b. Street Address (Cannot be a PO Box. If there is no address, provide other location information in 5p.) [help]			
7714 Taneum Rd West			
5c. City, State, Zip (If the project is not in a city or town, provide the name of the nearest city or town.) [help]			
Thorp WA 98944			
5d. County [help]			
Kittitas			

5e. Provide the section, township, and range for the project location. [\[help\]](#)

¼ Section	Section	Township	Range
	01	18	16

5f. Provide the latitude and longitude of the project location. [\[help\]](#)

- Example: 47.03922 N lat. / -122.89142 W long. (NAD 83)

5g. List the tax parcel number(s) for the project location. [\[help\]](#)

- The local county assessor's office can provide this information.

346333

5h. Contact information for all adjoining property owners. (If you need more space, use JARPA Attachment C.) [\[help\]](#)

Name	Mailing Address	Tax Parcel # (if known)

5i. List all wetlands on or adjacent to the project location. [\[help\]](#)

Taneum Creek

5j. List all waterbodies (other than wetlands) on or adjacent to the project location. [\[help\]](#)

Taneum Creek

5k. Is any part of the project area within a 100-year flood plain? [\[help\]](#)

- Yes No Don't know

5l. Briefly describe the vegetation and habitat conditions on the property. [\[help\]](#)

Pine, fir and grazing ground.
Currently active horse farm

5m. Describe how the property is currently used. [\[help\]](#)

Horse Farm

5n. Describe how the adjacent properties are currently used. [\[help\]](#)

~~D.W.F.~~ Department of fish + Wildlife
Rocky mt. Elk Foundation

5o. Describe the structures (above and below ground) on the property, including their purpose(s). [\[help\]](#)

House, hay storage barn
small horse shelter sheds

5p. Provide driving directions from the closest highway to the project location, and attach a map. [\[help\]](#)

Via Thorp Hwy North, Thorp Cemetery
Road West, approx. 6 miles, last
residence Taneum Canyon
7710 Taneum

Part 6—Project Description

6a. Summarize the overall project. You can provide more detail in 6d. [\[help\]](#)

Shoring + armoring Bridge Abutment

6b. Indicate the project category. (Check all that apply) [\[help\]](#)

- Commercial
 Residential
 Institutional
 Transportation
 Recreational
 Maintenance
 Environmental Enhancement

6c. Indicate the major elements of your project. (Check all that apply) [\[help\]](#)

- | | | | |
|--|---|--|--|
| <input type="checkbox"/> Aquaculture | <input type="checkbox"/> Culvert | <input type="checkbox"/> Float | <input type="checkbox"/> Road |
| <input checked="" type="checkbox"/> Bank Stabilization | <input type="checkbox"/> Dam / Weir | <input type="checkbox"/> Geotechnical Survey | <input type="checkbox"/> Scientific Measurement Device |
| <input type="checkbox"/> Boat House | <input type="checkbox"/> Dike / Levee / Jetty | <input type="checkbox"/> Land Clearing | <input type="checkbox"/> Stairs |
| <input type="checkbox"/> Boat Launch | <input type="checkbox"/> Ditch | <input type="checkbox"/> Marina / Moorage | <input type="checkbox"/> Stormwater facility |
| <input type="checkbox"/> Boat Lift | <input type="checkbox"/> Dock / Pier | <input type="checkbox"/> Mining | <input type="checkbox"/> Swimming Pool |
| <input checked="" type="checkbox"/> Bridge | <input type="checkbox"/> Dredging | <input type="checkbox"/> Outfall Structure | <input type="checkbox"/> Utility Line |
| <input type="checkbox"/> Bulkhead | <input type="checkbox"/> Fence | <input type="checkbox"/> Piling | |
| <input type="checkbox"/> Buoy | <input type="checkbox"/> Ferry Terminal | <input type="checkbox"/> Retaining Wall (upland) | |
| <input type="checkbox"/> Channel Modification | <input type="checkbox"/> Fishway | | |

Other:

6d. Describe how you plan to construct each project element checked in 6c. Include specific construction methods and equipment to be used. [\[help\]](#)

- Identify where each element will occur in relation to the nearest waterbody.
- Indicate which activities are within the 100-year flood plain.

Excavate ~~above~~ below stream bed.
Install ecology blocks to pour bridge abutment form above

6e. What are the start and end dates for project construction? (month/year) [\[help\]](#)

- If the project will be constructed in phases or stages, use [JARPA Attachment D](#) to list the start and end dates of each phase or stage.

Start date: ASAP

End date: 2 weeks from start date See JARPA Attachment D

6f. Describe the purpose of the project and why you want or need to perform it. [\[help\]](#)

Repair Failing Bridge Abutment

6g. Fair market value of the project, including materials, labor, machine rentals, etc. [\[help\]](#)

\$20,000

6h. Will any portion of the project receive federal funding? [\[help\]](#)

- If yes, list each agency providing funds.

Yes No Don't know

Part 7–Wetlands: Impacts and Mitigation

- Check here if there are wetlands or wetland buffers on or adjacent to the project area.
(If there are none, skip to Part 8.) [\[help\]](#)

7a. Describe how the project has been designed to avoid and minimize adverse impacts to wetlands. [\[help\]](#)

Not applicable

7b. Will the project impact wetlands? [\[help\]](#)

Yes No Don't know

7c. Will the project impact wetland buffers? [\[help\]](#)

Yes No Don't know

7d. Has a wetland delineation report been prepared? [\[help\]](#)

- If yes, submit the report, including data sheets, with the JARPA package.

Yes No

7e. Have the wetlands been rated using the Western Washington or Eastern Washington Wetland Rating System? [\[help\]](#)

- If yes, submit the wetland rating forms and figures with the JARPA package.

Yes No Don't know

7f. Have you prepared a mitigation plan to compensate for any adverse impacts to wetlands? [\[help\]](#)

- If yes, submit the plan with the JARPA package and answer 7g.
- If No, or Not applicable, explain below why a mitigation plan should not be required.

Yes No Not applicable

7g. Summarize what the mitigation plan is meant to accomplish, and describe how a watershed approach was used to design the plan. [\[help\]](#)

7h. Use the table below to list the type and rating of each wetland impacted; the extent and duration of the impact; and the type and amount of mitigation proposed. Or if you are submitting a mitigation plan with a similar table, you can state (below) where we can find this information in the plan. [\[help\]](#)

Activity (fill, drain, excavate, flood, etc.)	Wetland Name ¹	Wetland type and rating category ²	Impact area (sq. ft. or Acres)	Duration of impact ³	Proposed mitigation type ⁴	Wetland mitigation area (sq. ft. or acres)

¹ If no official name for the wetland exists, create a unique name (such as "Wetland 1"). The name should be consistent with other project documents, such as a wetland delineation report.

² Ecology wetland category based on current Western Washington or Eastern Washington Wetland Rating System. Provide the wetland rating forms with the JARPA package.

³ Indicate the days, months or years the wetland will be measurably impacted by the activity. Enter "permanent" if applicable.

⁴ Creation (C), Re-establishment/Rehabilitation (R), Enhancement (E), Preservation (P), Mitigation Bank/In-lieu fee (B)

Page number(s) for similar information in the mitigation plan, if available: _____

7i. For all filling activities identified in 7h., describe the source and nature of the fill material, the amount in cubic yards that will be used, and how and where it will be placed into the wetland. [\[help\]](#)

7j. For all excavating activities identified in 7h., describe the excavation method, type and amount of material in cubic yards you will remove, and where the material will be disposed. [\[help\]](#)

Part 8–Waterbodies (other than wetlands): Impacts and Mitigation

In Part 8, "waterbodies" refers to non-wetland waterbodies. (See Part 7 for information related to wetlands.) [\[help\]](#)

Check here if there are waterbodies on or adjacent to the project area. (If there are none, skip to Part 9.)

8a. Describe how the project is designed to avoid and minimize adverse impacts to the aquatic environment.

[\[help\]](#)

Not applicable

8b. Will your project impact a waterbody or the area around a waterbody? [\[help\]](#)

Yes No

8c. Have you prepared a mitigation plan to compensate for the project's adverse impacts to non-wetland waterbodies? [\[help\]](#)

- If **yes**, submit the plan with the JARPA package and answer 8d.
- If **No**, or **Not applicable**, explain below why a mitigation plan should not be required.

Yes No Not applicable

8d. Summarize what the mitigation plan is meant to accomplish. Describe how a watershed approach was used to design the plan.

- If you already completed 7g., you do not need to restate your answer here. [\[help\]](#)

8e. Summarize impact(s) to each waterbody in the table below. [\[help\]](#)

Activity (clear, dredge, fill, pile drive, etc.)	Waterbody name ¹	Impact location ²	Duration of impact ³	Amount of material to be placed in or removed from waterbody	Area (sq. ft. or linear ft.) of waterbody directly affected

¹ If no official name for the waterbody exists, create a unique name (such as "Stream 1") The name should be consistent with other documents provided.

² Indicate whether the impact will occur in or adjacent to the waterbody. If adjacent, provide the distance between the impact and the waterbody and indicate whether the impact will occur within the 100-year flood plain.

³ Indicate the days, months or years the waterbody will be measurably impacted by the work. Enter "permanent" if applicable.

8f. For all activities identified in 8e., describe the source and nature of the fill material, amount (in cubic yards) you will use, and how and where it will be placed into the waterbody. [\[help\]](#)

8g. For all excavating or dredging activities identified in 8e., describe the method for excavating or dredging, type and amount of material you will remove, and where the material will be disposed. [\[help\]](#)

Part 9—Additional Information

Any additional information you can provide helps the reviewer(s) understand your project. Complete as much of this section as you can. It is ok if you cannot answer a question.

9a. If you have already worked with any government agencies on this project, list them below. [help]			
Agency Name	Contact Name	Phone	Most Recent Date of Contact
		()	
		()	
		()	
9b. Are any of the wetlands or waterbodies identified in Part 7 or Part 8 on the Washington Department of Ecology's 303(d) List? [help] <ul style="list-style-type: none"> ▪ If yes, list the parameter(s) below. ▪ If you don't know, use Washington Department of Ecology's Water Quality Assessment tools at: http://www.ecy.wa.gov/programs/wq/303d/. 			
<input type="checkbox"/> Yes <input type="checkbox"/> No			
9c. What U.S. Geological Survey Hydrological Unit Code (HUC) is the project in? [help] <ul style="list-style-type: none"> ▪ Go to http://cfpub.epa.gov/surf/locate/index.cfm to help identify the HUC. 			
9d. What Water Resource Inventory Area Number (WRIA #) is the project in? [help] <ul style="list-style-type: none"> ▪ Go to http://www.ecy.wa.gov/services/gis/maps/wria/wria.htm to find the WRIA #. 			
9e. Will the in-water construction work comply with the State of Washington water quality standards for turbidity? [help] <ul style="list-style-type: none"> ▪ Go to http://www.ecy.wa.gov/programs/wq/swqs/criteria.html for the standards. 			
<input checked="" type="checkbox"/> Yes <input type="checkbox"/> No <input type="checkbox"/> Not applicable			
9f. If the project is within the jurisdiction of the Shoreline Management Act, what is the local shoreline environment designation? [help] <ul style="list-style-type: none"> ▪ If you don't know, contact the local planning department. ▪ For more information, go to: http://www.ecy.wa.gov/programs/sea/sma/laws_rules/173-26/211_designations.html. 			
<input type="checkbox"/> Rural <input type="checkbox"/> Urban <input type="checkbox"/> Natural <input type="checkbox"/> Aquatic <input type="checkbox"/> Conservancy <input type="checkbox"/> Other _____			
9g. What is the Washington Department of Natural Resources Water Type? [help] <ul style="list-style-type: none"> ▪ Go to http://www.dnr.wa.gov/BusinessPermits/Topics/ForestPracticesApplications/Pages/fp_watertyping.aspx for the Forest Practices Water Typing System. 			
<input type="checkbox"/> Shoreline <input type="checkbox"/> Fish <input type="checkbox"/> Non-Fish Perennial <input type="checkbox"/> Non-Fish Seasonal			

9h. Will this project be designed to meet the Washington Department of Ecology's most current stormwater manual? [\[help\]](#)

- If no, provide the name of the manual your project is designed to meet.

Yes No

Name of manual:

9i. If you know what the property was used for in the past, describe below. [\[help\]](#)

same

9j. Has a cultural resource (archaeological) survey been performed on the project area? [\[help\]](#)

- If yes, attach it to your JARPA package.

Yes No

9k. Name each species listed under the federal Endangered Species Act that occurs in the vicinity of the project area or might be affected by the proposed work. [\[help\]](#)

9l. Name each species or habitat on the Washington Department of Fish and Wildlife's Priority Habitats and Species List that might be affected by the proposed work. [\[help\]](#)

Part 10–SEPA Compliance and Permits

Use the resources and checklist below to identify the permits you are applying for.

- Online Project Questionnaire at <http://apps.ecy.wa.gov/opus/>.
- Governor's Office of Regulatory Assistance at (800) 917-0043 or help@ora.wa.gov.
- For a list of agency addresses to send your application, click on the "where to send your completed JARPA" at <http://www.epermitting.wa.gov>.

10a. Compliance with the State Environmental Policy Act (SEPA). (Check all that apply.) [\[help\]](#)

- For more information about SEPA, go to www.ecy.wa.gov/programs/sea/sepa/e-review.html.

- A copy of the SEPA determination or letter of exemption is included with this application.
- A SEPA determination is pending with _____ (lead agency). The expected decision date is _____.
- I am applying for a Fish Habitat Enhancement Exemption. (Check the box below in 10b.) [\[help\]](#)
- This project is exempt (choose type of exemption below).
- Categorical Exemption. Under what section of the SEPA administrative code (WAC) is it exempt?

 - Other: _____
- SEPA is pre-empted by federal law.

10b. Indicate the permits you are applying for. (Check all that apply.) [\[help\]](#)

LOCAL GOVERNMENT

Local Government Shoreline permits:

- Substantial Development Conditional Use Variance
- Shoreline Exemption Type (explain): _____

Other city/county permits:

- Floodplain Development Permit Critical Areas Ordinance

STATE GOVERNMENT

Washington Department of Fish and Wildlife:

- Hydraulic Project Approval (HPA) Fish Habitat Enhancement Exemption

Washington Department of Ecology:

- Section 401 Water Quality Certification

Washington Department of Natural Resources:

- Aquatic Resources Use Authorization

FEDERAL GOVERNMENT

United States Department of the Army permits (U.S. Army Corps of Engineers):

- Section 404 (discharges into waters of the U.S.) Section 10 (work in navigable waters)

United States Coast Guard permits:

- General Bridge Act Permit Private Aids to Navigation (for non-bridge projects)

Part 11—Authorizing Signatures

Signatures are required before submitting the JARPA package. The JARPA package includes the JARPA form, project plans, photos, etc. [\[help\]](#)

11a. Applicant Signature (required) [\[help\]](#)

I certify that to the best of my knowledge and belief, the information provided in this application is true, complete, and accurate. I also certify that I have the authority to carry out the proposed activities, and I agree to start work only after I have received all necessary permits.

I hereby authorize the agent named in Part 3 of this application to act on my behalf in matters related to this application. JS (initial)

By initialing here, I state that I have the authority to grant access to the property. I also give my consent to the permitting agencies entering the property where the project is located to inspect the project site or any work related to the project. JS (initial)

Louise Gibson
Applicant Printed Name

[Signature]
Applicant Signature

12-30-10
Date

11b. Authorized Agent Signature [\[help\]](#)

I certify that to the best of my knowledge and belief, the information provided in this application is true, complete, and accurate. I also certify that I have the authority to carry out the proposed activities and I agree to start work only after all necessary permits have been issued.

Authorized Agent Printed Name

Authorized Agent Signature

Date

11c. Property Owner Signature (if not applicant). [\[help\]](#)

Not required if project is on existing rights-of-way or easements.

I consent to the permitting agencies entering the property where the project is located to inspect the project site or any work. These inspections shall occur at reasonable times and, if practical, with prior notice to the landowner.

Property Owner Printed Name

Property Owner Signature

Date

18 U.S.C §1001 provides that: Whoever, in any manner within the jurisdiction of any department or agency of the United States knowingly falsifies, conceals, or covers up by any trick, scheme, or device a material fact or makes any false, fictitious, or fraudulent statements or representations or makes or uses any false writing or document knowing same to contain any false, fictitious, or fraudulent statement or entry, shall be fined not more than \$10,000 or imprisoned not more than 5 years or both.

If you require this document in another format, contact The Governor's Office of Regulatory Assistance (ORA). People with hearing loss can call 711 for Washington Relay Service. People with a speech disability can call (877) 833-6341.
ORA publication number: ENV-019-09

Part 11--Authorizing Signatures

Signatures are required before submitting the JARPA package. The JARPA package includes the JARPA form, project plans, photos, etc. [help](#)

11a. Applicant Signature [help](#)

I certify that to the best of my knowledge and belief, the information provided in this application is true, complete, and accurate. I also certify that I have the authority to carry out the proposed activities, and I agree to start work only after I have received all necessary permits.

I hereby authorize the agent named in Part 3 of this application to act on my behalf in matters related to this application. JS (initials)

By initialing here, I state that I have the authority to grant access to the property. I also give my consent to the permitting agencies entering the property where the project is located to inspect the project site or any work related to the project. JS (initials)

Louise Carlson Applicant Printed Name [Signature] Applicant Signature 12-30-10 Date

11b. Authorized Agent Signature [help](#)

I certify that to the best of my knowledge and belief, the information provided in this application is true, complete, and accurate. I also certify that I have the authority to carry out the proposed activities and I agree to start work only after all necessary permits have been issued.

Authorized Agent/Printed Name Authorized Agent Signature Date

11c. Property Owner Signature (if not applicant). [help](#) Not required if project is on existing rights-of-way or easements.

I consent to the permitting agencies entering the property where the project is located to inspect the project site or any work. These inspections shall occur at reasonable times and, if practical, with prior notice to the landowner.

Gene Brain Property Owner Printed Name [Signature] Property Owner Signature 12-30-10 Date

18 U.S.C. §1001 provides that: Whoever, in any manner within the jurisdiction of any department or agency of the United States knowingly falsifies, conceals, or covers up by any trick, scheme, or device a material fact or makes any false, fictitious, or fraudulent statement or representations or makes or uses any false writing or document knowing same to contain any false, fictitious, or fraudulent statement or entry, shall be fined not more than \$10,000 or imprisoned not more than 5 years or both.

If you require this document in another format, contact The Governor's Office of Regulatory Assistance (ORA). People with hearing loss can call 711 for Washington Relay Service. People with a speech disability can call (877) 833-6241.
ORA publication number: ENV 019-08

Existing Abutment (South)

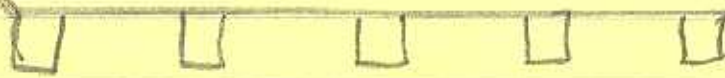

Flow ← Tancum Cr.

Sand Bags

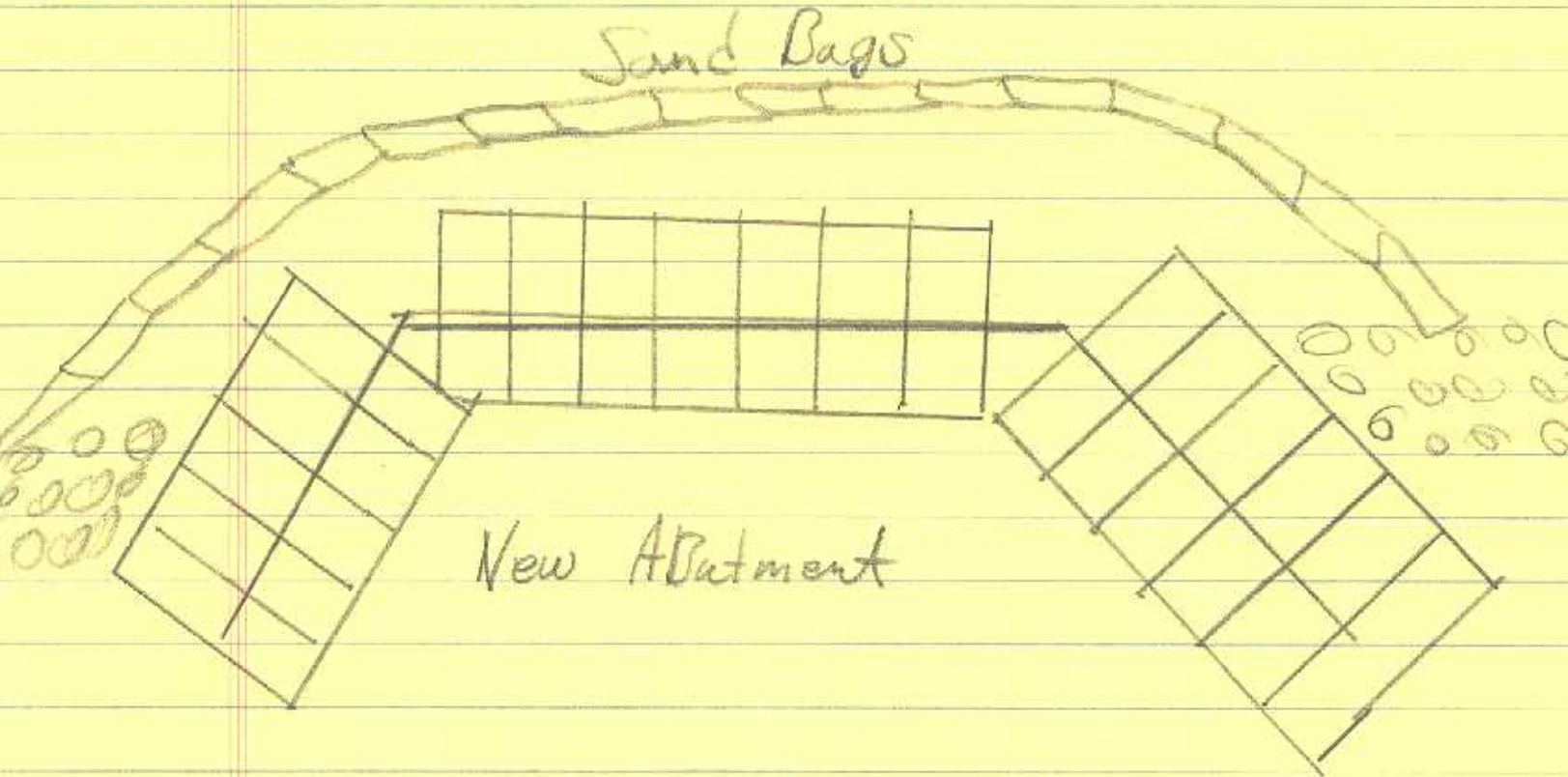

New Abutment